

A1 INSTALLATION DRAWING

IF THIS DOCUMENT IS PRINTED IN HARDCOPY, IT IS FOR INFORMATION USE ONLY AND THEREFORE IS NOT SUBJECT TO UPDATING CONTROLS. ALWAYS REFER TO SOLIDWORKS VIEWER FOR LATEST ISSUE



THIS DRAWING IS CONFIDENTIAL AND IS SUPPLIED ON THE EXPRESS CONDITION THAT IT SHALL NOT BE LOANED OR COPIED OR DISCLOSED TO ANY OTHER PERSON OR USED FOR ANY OTHER PURPOSE WITHOUT THE WRITTEN CONSENT OF AP RACING LTD.



AP Racing
Wheler Road
Coventry
CV3 4LB

Tel: +44 (0) 24 7663 9595
Fax: +44 (0) 24 7663 9559
e-mail: engineering@apracings.co.uk
Web site: <http://www.apracings.com>

© AP Racing Ltd. 2017

DISC PART NUMBERS

CP3836-2018 RH AS DRAWN
CP3836-2019 LH OPPOSITE

THIS IS A 36 VANE DISC OF MASS 5.96Kg

THIS DISC WAS DESIGNED TO WORK WITH A D53 DEPTH PAD

SUFFIX TO DISC PART NUMBERS:-

SUFFIX DETAILS

P PLAIN (NO GROOVES)
Gnn STRAIGHT GROOVES AS SHOWN, VALUE nn PER FACE.
eg G8 MEANS 8 GROOVVES PER FACE.

FOR DISC MOUNTING TECHNIQUES, BEDDING PROCEDURE AND DISC COOLING RECOMMENDATIONS SEE AP RACING BRAKE DISC CATALOGUE.

DISC INSTALLATION

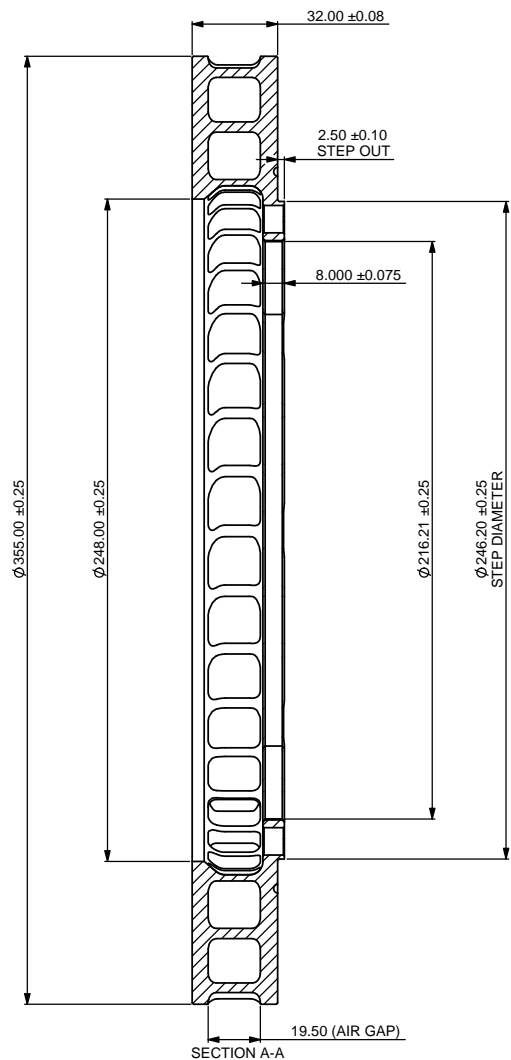
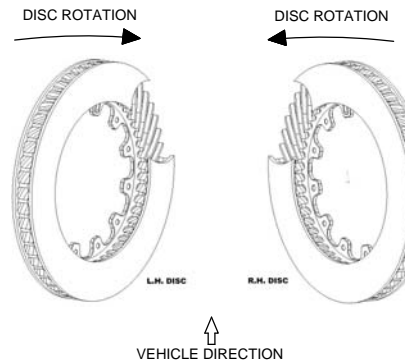

10 MTG SLOTS EQUI-SPACED ON A 233.00 PCD

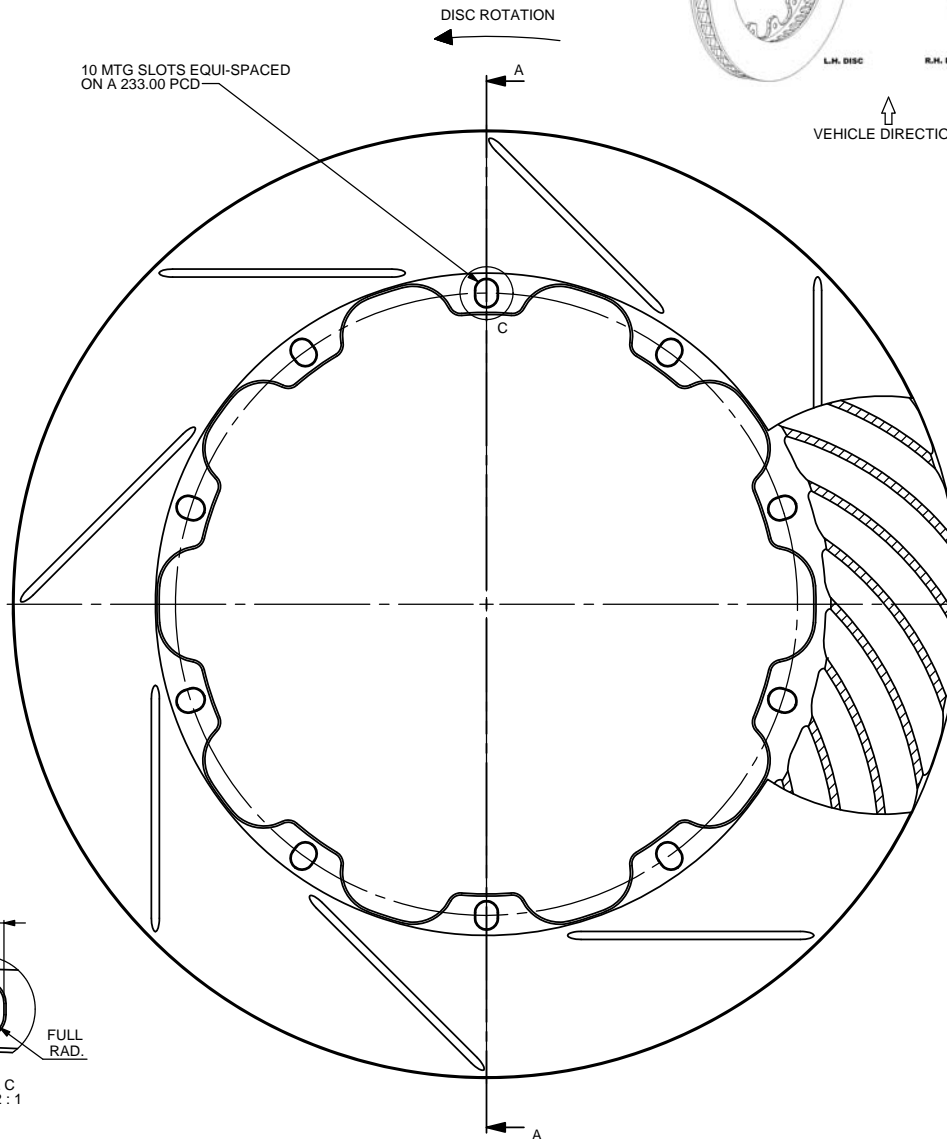
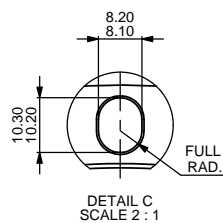

Issue No.	Date & No.	Alterations		Zone	Initials
		Particulars	#		
1	13/12/17 B7816	FIRST ISSUE			CH

SCALE 1:1 SHEET 1 OF 1

DRAWN Connor Homeyard

APPROVED

DERIVED FROM

TITLE
Ø355.0 x 32.0
VENTILATED DISC

DRG NO. CP3836-2018 / 2019 CD